

6

**SERBATOI
TANKS**



SERBATOI

I nostri serbatoi sono studiati per adattarsi alle tantissime configurazioni dei telai di veicoli industriali. Per montaggio nel contro telaio, laterale o retro cabina la nostra gamma è particolarmente versatile per meglio agevolare l'installazione dei nostri kit idraulici sui veicoli industriali. Le versioni aggiuntive con filtrazione sulla tubazione di ritorno al serbatoio o con montaggio delle valvole distributrici direttamente sul serbatoio completano la nostra offerta, proponendo soluzioni orientate alla più ampia flessibilità ed alla semplicità di montaggio.

TANKS

Our tanks are designed for fitting to the most configurations of the industrial vehicles' chassis. Our range is very versatile for helping the installation of our hydraulic kits on the industrial vehicles, in case of underbody, side or rear mounting. The additional models with filtering on the return pipe to the tank or with mounting of the distribution valves directly on the tank, complete our proposals, offering solutions for a greater flexibility and an easier assembly.

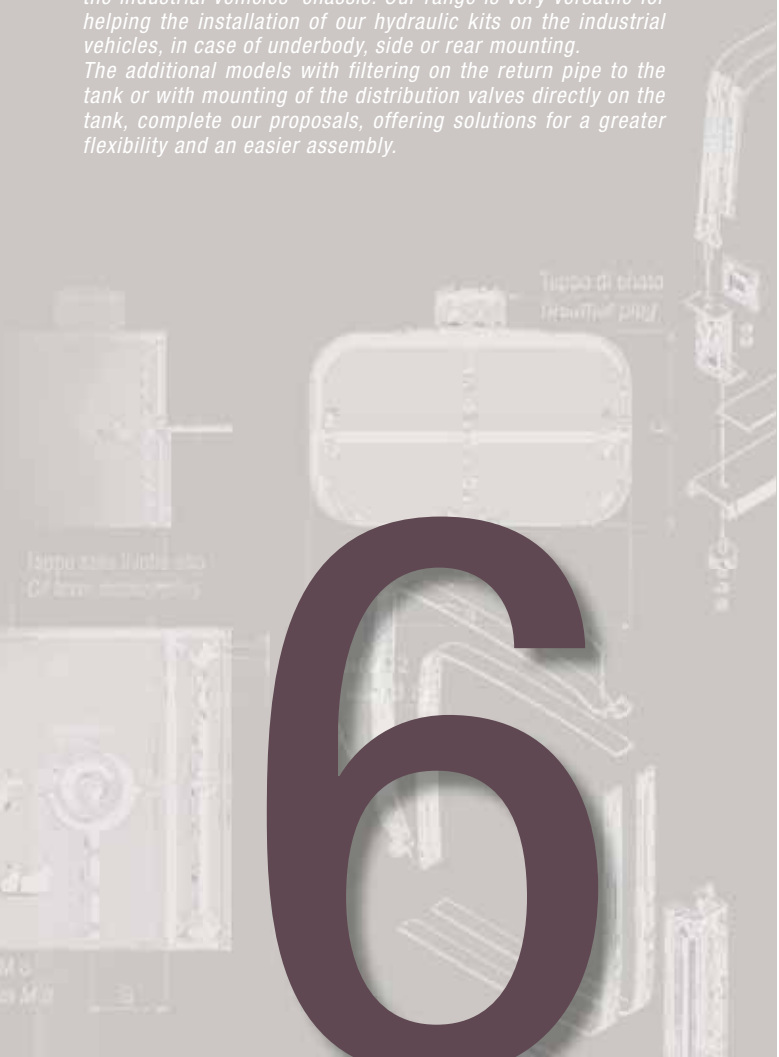

< in motion to the future >

catalogo generale *general catalogue*

MONTAGGIO SOTTO-CASSONE
UNDERBODY MOUNTING

SB PF



CODICE DI ORDINAZIONE / *ORDERING CODE*

SB S A 021 D G 0 0

PERSONALIZZAZIONI / *PERSONALIZED*
0 = NESSUNA / *NONE*

POSIZIONE PIASTRA / *PLATE POSITION*
0 = NO PIASTRA / *NO PLATE*

COLORE / *COLOUR*
G = GRIGIO / *GREY*

ALLESTIMENTO / *EQUIPMENT*
SERBATOIO PREDISPOSTO PER FILTRO CON TAPPO SFIATO
PREARRANGED FOR FILTER TANK WITH BREATHER PLUG

CAPACITÀ SERBATOIO (lt) / *TANK CAPACITY (lt)*

MATERIALE / *MATERIAL*
A = ACCIAIO / *STEEL*

S = MONTAGGIO SOTTO-CASSONE / *UNDERBODY MOUNTED*

SERBATOI PREDISPOSTI PER FILTRO
PREARRANGED FOR FILTER TANK

SB PF 21

SB PF 34

SB PF 47

SB PF 60

MODELLO / *MODEL*

CARATTERISTICHE E DATI TECNICI / *SPECIFICATIONS AND TECHNICAL DATA*

TIPO <i>TYPE</i>	CODICE <i>CODE</i>	CAPACITÀ <i>CAPACITY</i> (litri - <i>litres</i>)	DIMENSIONI / <i>DIMENSIONS</i>						
			A	B	C	D	E	F	G
SB PF 21	SBSA021DG00	21	370	320	195	65	1'	100	75
SB PF 34	SBSA034DG00	34	370	520	195	65	1'	100	75
SB PF 47	SBSA047DG00	47	360	500	290	65	1' ¼	150	100
SB PF 60	SBSA060DG00	60	360	640	290	65	1' ¼	150	100

> Serbatoi in materiale metallico colore standard grigio
(a richiesta altre tipologie e accessori).

> *Metallic oil tank- standard colour: grey
(other versions and accessories available upon request).*

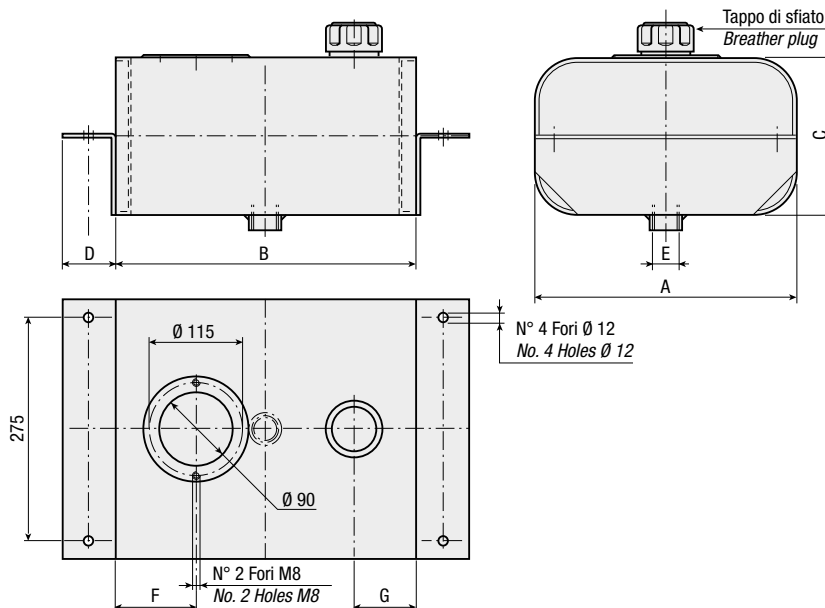

catalogo generale *general catalogue*

MONTAGGIO LATERALE
SIDE MOUNTING

CODICE DI ORDINAZIONE / *ORDERING COD*

SB L A 055 B G 0 0

PERSONALIZZAZIONI / *PERSONALIZED*
0 = NESSUNA / *NONE*

POSIZIONE PIASTRA / *PLATE POSITION*
0 = NO PIASTRA / *NO PLATE*

COLORE / *COLOUR*
G = GRIGIO / *GREY*

ALLESTIMENTO / *EQUIPMENT*
SERBATOIO BASE + TAPPO SFIATO / *STANDARD TANK + BREATHER PLUG*

CAPACITÀ SERBATOIO (lt) / *TANK CAPACITY (lt)*

MATERIALE / *MATERIAL*
A = ACCIAIO / *STEEL*

L = MONTAGGIO LATERALE / *SIDE MOUNTING*

MODELLO / *MODEL*

SB

SB 55

Serbatoio
Tank



CARATTERISTICHE E DATI TECNICI / *SPECIFICATIONS AND TECHNICAL DATA*

TIPO <i>TYPE</i>	CODICE <i>CODE</i>	CAPACITÀ <i>CAPACITY</i>	X <i>(mm)</i>
SB 55	SBLA055BG00	55 lt	240

> Serbatoi in materiale metallico colore standard grigio
(a richiesta altre tipologie e accessori).

> *Metallic oil tank- standard colour: grey
(other versions and accessories available upon request).*

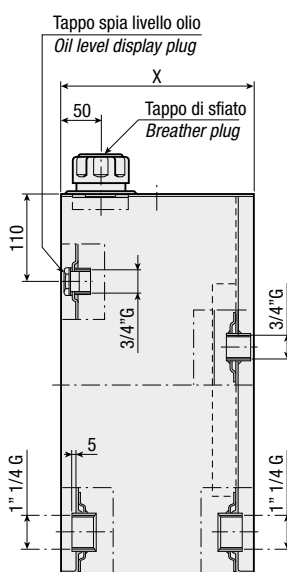
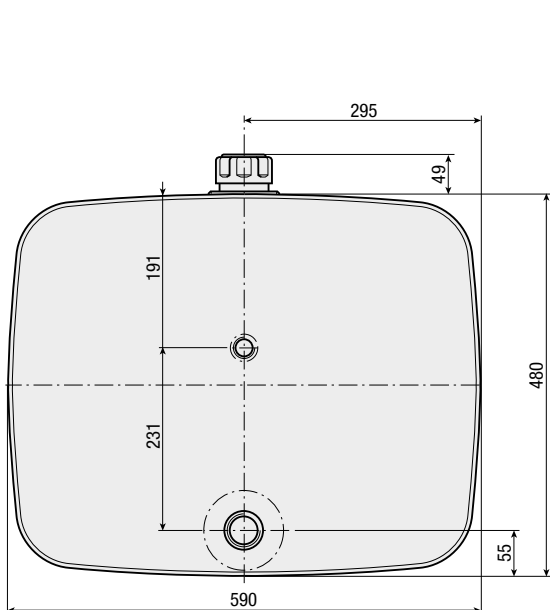

KIT STAFFE DI FISSAGGIO
BRACKETS KITS

CODICE / CODE: 911SS000001

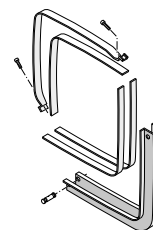

SERBATOI TANKS

131

catalogo generale *general catalogue*

MONTAGGIO RETRO-CABINA
REAR MOUNTED

ST PF



CODICE DI ORDINAZIONE / *ORDERING CODE*

ST R A 066 K G 0 0

PERSONALIZZAZIONI / *PERSONALIZED*
0 = NESSUNA / *NONE*

POSIZIONE PIASTRA / *PLATE POSITION*
0 = NO PIASTRA / *NO PLATE*

COLORE / *COLOUR*
G = GRIGIO / *GREY*

ALLESTIMENTO / *EQUIPMENT*
PREDISPOSTO PER FLEXIKIT
PREARRANGED FOR FLEXIKIT

CAPACITÀ SERBATOIO (lt) / *TANK CAPACITY (lt)*

MATERIALE / *MATERIAL*
A = ACCIAIO / *STEEL*

R = MONTAGGIO RETRO-CABINA / *REAR MOUNTED*

SERBATOIO OLIO RETRO-CABINA
OIL TANK - REAR MOUNTED

ST PF 066

MODELLO / *MODEL*

CARATTERISTICHE E DATI TECNICI / *SPECIFICATIONS AND TECHNICAL DATA*

TIPO <i>TYPE</i>	CODICE <i>CODE</i>	CAPACITÀ <i>CAPACITY</i> (litri - litres)	DIMENSIONI / <i>DIMENSIONS</i>		
			A	B	C
ST PF 066	STRA066KG00	66 lt	278	460	638

> Colore standard grigio. Altri colori su richiesta con sovrapprezzo

> *Standard colour grey. Other colours on demand with overprice.*

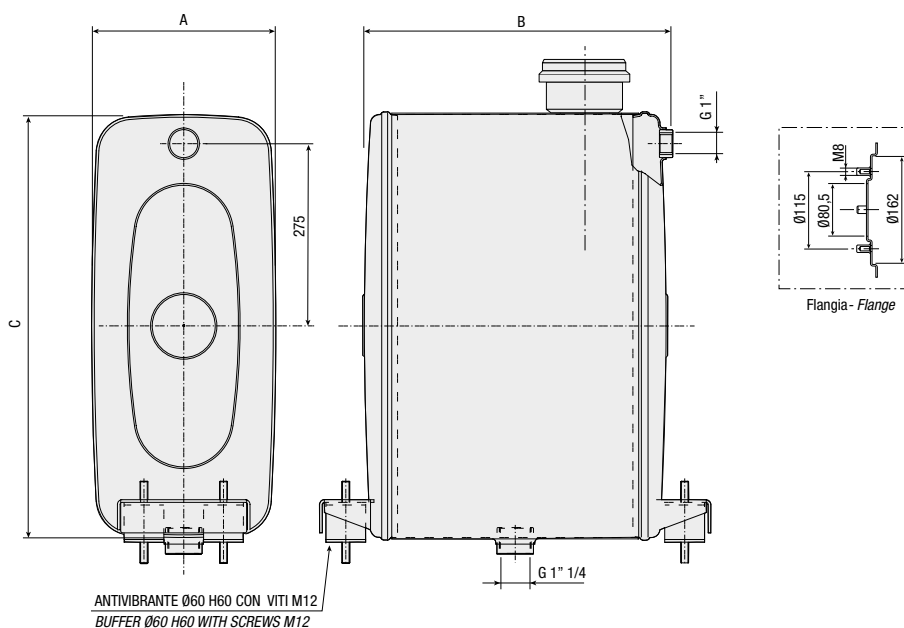

catalogo generale *general catalogue*

MONTAGGIO RETRO-CABINA
REAR MOUNTED

CODICE DI ORDINAZIONE / *ORDERING COD*

ST R A 100 K G 0 0

PERSONALIZZAZIONI / *PERSONALIZED*
0 = NESSUNA / *NONE*

POSIZIONE PIASTRA / *PLATE POSITION*
0 = NO PIASTRA / *NO PLATE*

COLORE / *COLOUR*
G = GRIGIO / *GREY*

ALLESTIMENTO / *EQUIPMENT*
PREDISPOSTO PER FLEXIKIT
PREARRANGED FOR FLEXIKIT

CAPACITÀ SERBATOIO (lt) / *TANK CAPACITY (lt)*

MATERIALE / *MATERIAL*
A = ACCIAIO / *STEEL*

R = MONTAGGIO RETRO-CABINA / *REAR MOUNTED*

MODELLO / *MODEL*

ST PF

SERBATOIO OLIO RETRO-CABINA
OIL TANK - REAR MOUNTED

ST PF 100

ST PF 135

ST PF 160

ST PF 200

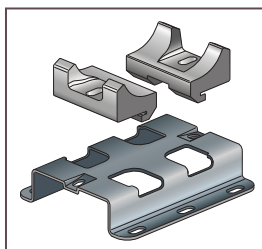

CARATTERISTICHE E DATI TECNICI / *SPECIFICATIONS AND TECHNICAL DATA*

TIPO <i>TYPE</i>	CODICE <i>CODE</i>	CAPACITÀ <i>CAPACITY</i> (litri - <i>litres</i>)	DIMENSIONI / <i>DIMENSIONS</i>
			X
ST PF 100	STRA100KG00	100 lt	640
ST PF 135	STRA135KG00	135 lt	840
ST PF 160	STRA160KG00	160 lt	1084
ST PF 200	STRA200KG00	200 lt	1300

> Colore standard grigio. Altri colori su richiesta con sovrapprezzo

> *Standard colour grey. Other colours on demand with overprice.*

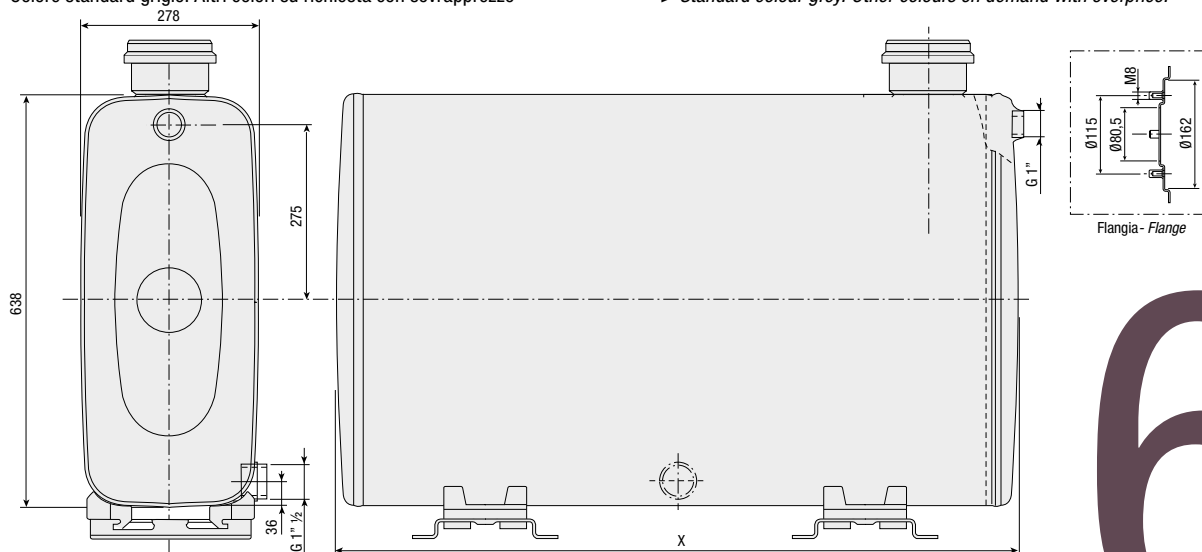

SERBATOI TANKS

6

catalogo generale *general catalogue*

MONTAGGIO RETRO-CABINA
REAR MOUNTED

CODICE DI ORDINAZIONE / ORDERING CODE

SB R A 230 K G 0 0

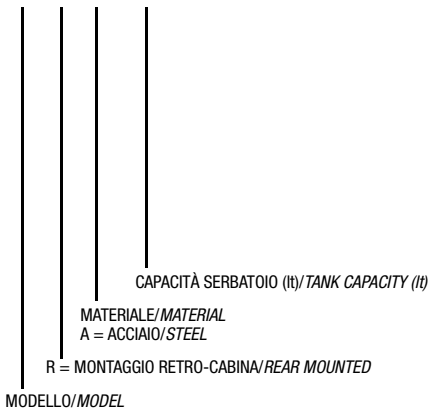

SB PF

SERBATOI PREDISPOSTI PER FILTRO
PREARRANGED FOR FILTER TANK

SB PF 230

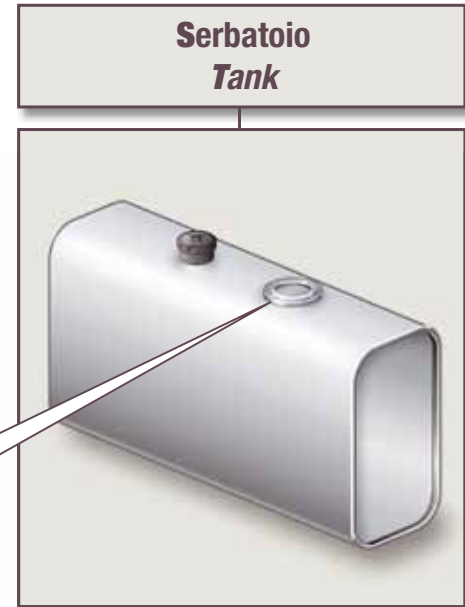
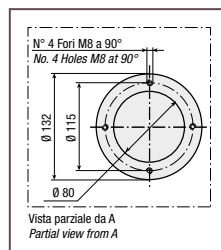

CARATTERISTICHE E DATI TECNICI / SPECIFICATIONS AND TECHNICAL DATA

TIPO TYPE	CODICE CODE	CAPACITÀ CAPACITY	DIMENSIONI DIMENSIONS (mm)
SB PF 230	SBRA230KG00	230 lt	330 x 1100

> Serbatoi in materiale metallico colore standard grigio (a richiesta altre tipologie e accessori).

> Metallic oil tank- standard colour: grey (other versions and accessories available upon request).

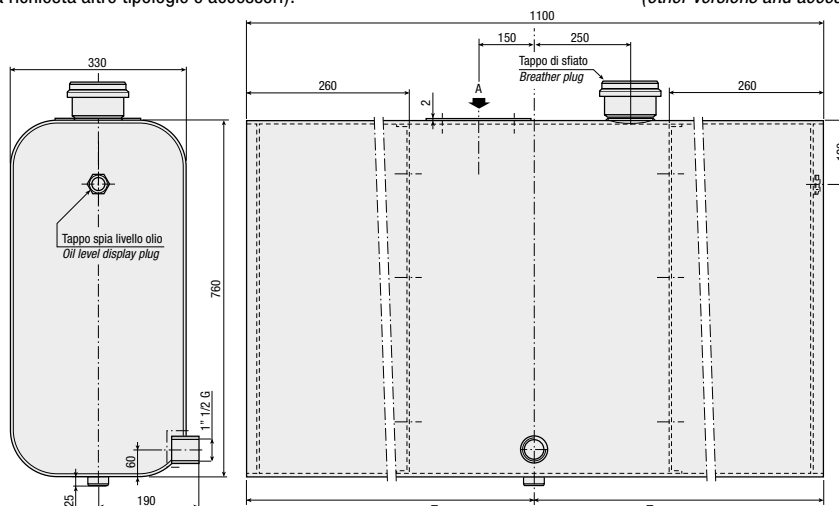

CODICE/CODE: 911SS000008

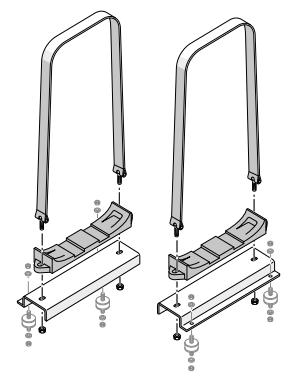

Non incluso / Not included

OPTIONAL

DESCRIZIONE DESCRIPTION	CODICE CODE	QUANTITÀ QUANTITY
Kit accessori per serbatoio retrocabina (antivibranti) Accessories kit for rear mounted tank (vibration dampers)	912SA000016	4

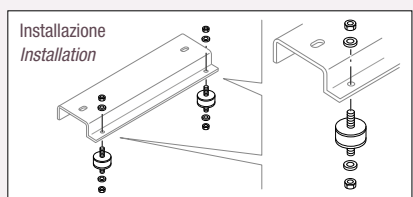
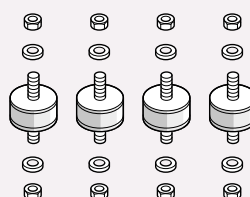

catalogo generale *general catalogue*

COMPONENTI COMPRESI NEI SERBATOI SP COMPONENTS INCLUDED IN THE TANKS SERIES SP

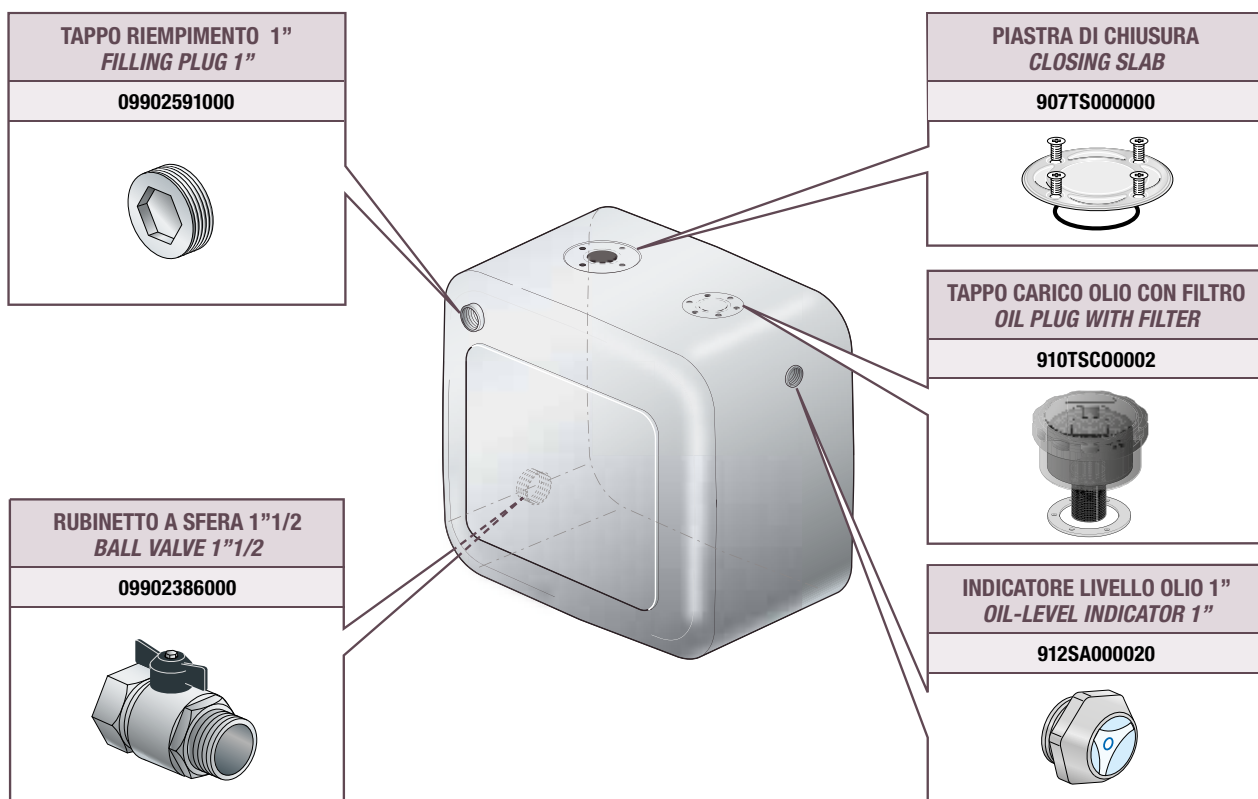

FISSAGGIO AL TELAIO / CHASSIS MOUNTING

KIT FISSAGGIO AL TELAIO / CHASSIS MOUNTING KIT
30KST000002

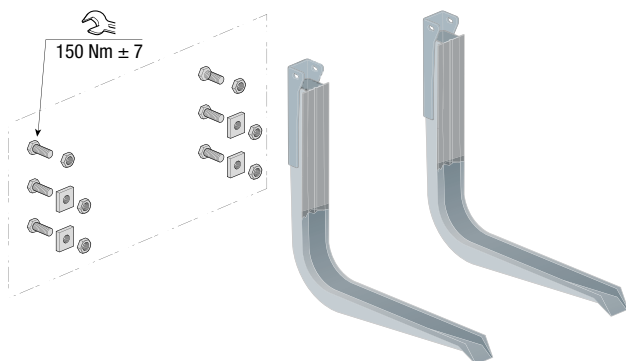

4	Piatto spessore 60x60x8 con foro ø16 / Shim bored disc 60x60x8 with hole ø16
4	Vite Flangiata / Flanged Screw TE M14X40 UNI EN1665
2	Vite Flangiata / Flanged Screw TE M14X50 UNI EN1665
6	Dado Flangiato / Flanged Nut M14 UNI EN1661

DIMENSIONE FORI PER IL FISSAGGIO / MOUNTING HOLE SIZE

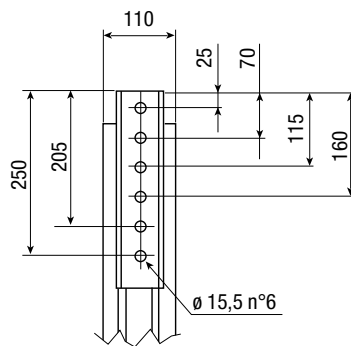

FISSARE CON MINIMO 3 VITI PER OGNI STAFFA / MOUNT BY MEANS OF 3 SCREWS FOR EACH BRACKET AT LEAST

SERBATOI / TANKS

135

catalogo generale *general catalogue*

MONTAGGIO LATERALE
SIDE MOUNTING

SP LA

Serbatoio *Tank*

CODICE DI ORDINAZIONE / *ORDERING CODE*

SP L A 090 K G 1 6

PERSONALIZZAZIONI / *PERSONALIZED*
PIASTRA CON FORATURA PER D160 E D180 lt
PLATE WITH BORING FOR D160 AND D180 lt

POSIZIONE PIASTRA / *PLATE POSITION*
1 = FRONTALE / *FRONTAL*
58 = PREDISPOSIZIONE PIASTRA SUPERIORE
PREARRANGED FOR UPPER PLATE

COLORE / *COLOUR*
G = GRIGIO / *GREY*

ALLESTIMENTO / *EQUIPMENT*
SERBATOIO BASE + TAPPO SFIATO / *STANDARD TANK + BREATHER PLUG*

CAPACITÀ SERBATOIO (lt) / *TANK CAPACITY (lt)*

MATERIALE / *MATERIAL*
A = ACCIAIO / *STEEL*
L = ALLUMINIO / *ALUMINIUM*
I = ACCIAIO INOX / *STAINLESS STEEL*

R = MONTAGGIO RETRO-CABINA / *REAR MOUNTED*

SP LA 090

SP LA 100

SP LA 120



MODELLO / *MODEL*

CARATTERISTICHE E DATI TECNICI / *SPECIFICATIONS AND TECHNICAL DATA*

TIPO <i>TYPE</i>	CODICE <i>CODE</i>	CAPACITÀ <i>CAPACITY</i>	X <i>(mm)</i>
SP LA 090	SPLA090KG16	90 lt	350
SP LA 100	SPLA100KG16	100 lt	400
SP LA 120	SPLA120KG16	120 lt	450

> Serbatoi in materiale metallico colore standard grigio
(a richiesta altre tipologie e accessori).

> *Metallic oil tank - standard colour: grey
(other versions and accessories available upon request).*

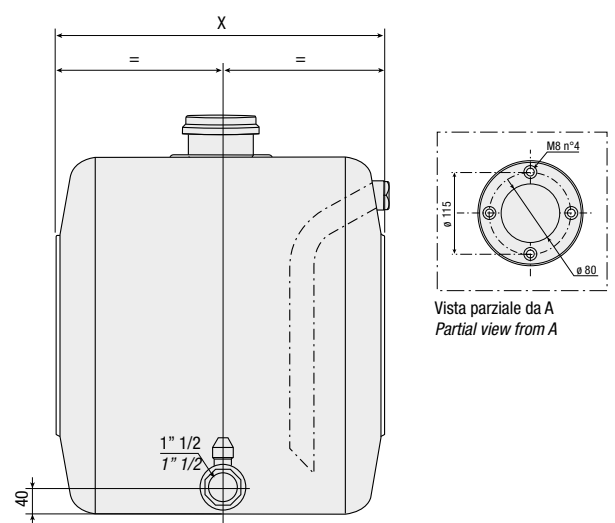
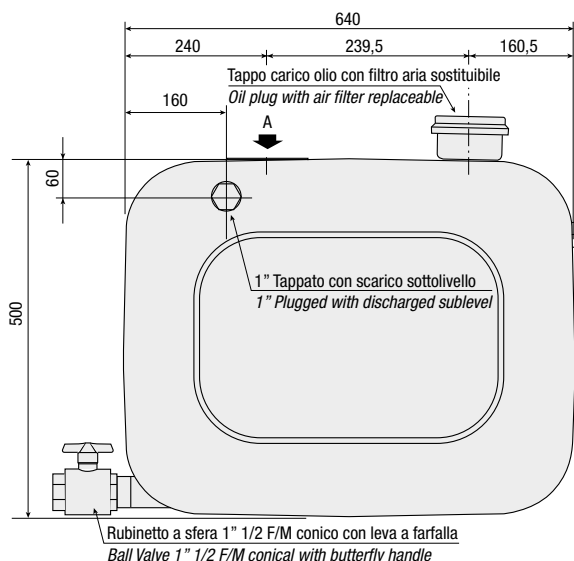

MONTAGGIO LATERALE
SIDE MOUNTING

SP LA

Serbatoio Tank

CODICE DI ORDINAZIONE / ORDERING CODE

SP L A 135 K G 5 8

SERBATOI PREDISPOSTI PER FILTRO
PREARRANGED FOR FILTER TANK

SP LA 135

SP LA 150

SP LA 170

SP LA 200



PERSONALIZZAZIONI/PERSONALIZED
0 = NESSUNA/NONE

POSIZIONE PIASTRA/PLATE POSITION
0 = NO PIASTRA/NO PLATE

COLORE/COLOUR
G = GRIGIO/GREY

ALLESTIMENTO/EQUIPMENT
SERBATOIO PREDISPOSTO PER FLEXIKIT
PREARRANGED FOR FLEXIKIT TANK

CAPACITÀ SERBATOIO (litri)/TANK CAPACITY (liters)

MATERIALE/MATERIAL
A = ACCIAIO/STEEL
L = ALLUMINIO/ALUMINIUM
I = ACCIAIO INOX/STAINLESS STEEL

R = MONTAGGIO RETRO-CABINA/REAR MOUNTED

MODELLO/MODEL

CARATTERISTICHE E DATI TECNICI / SPECIFICATIONS AND TECHNICAL DATA

TIPO TYPE	CODICE CODE	CAPACITÀ CAPACITY	X (mm)
SP LA 135	SPLA135KG58	135 lt	350
SP LA 150	SPLA150KG58	150 lt	400
SP LA 170	SPLA170KG58	170 lt	450
SP LA 200	SPLA200KG58	200 lt	500

> Serbatoi in materiale metallico colore standard grigio
(a richiesta altre tipologie e accessori).

> Metallic oil tank- standard colour: grey
(other versions and accessories available upon request).

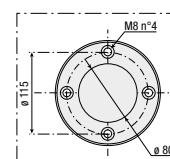
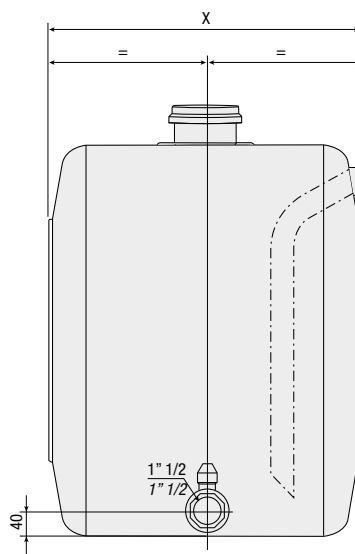
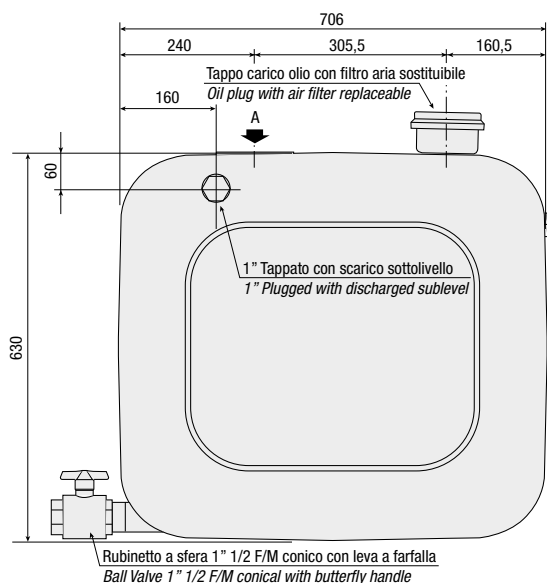

Vista parziale da A
Partial view from A





SERBATOI TANKS

6

137

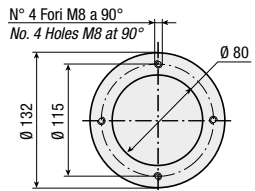
catalogo generale *general catalogue*

FILTRI SUL RITORNO CON VALVOLA BY-PASS / RETURN FILTERS WITH BYPASS VALVE

DIMENSIONI FLANGIATURA / FLANGE SIZE 	PORTATA CAPACITY Lt	FILTRAZIONE FILTERING	ATTACCO PORT	CARTUCCIA: TIPO/CODICE CARTRIDGE: TYPE/CODE	CODICE CODE
Tipo/Type (1) 	70	25 MICRON	1"	CARTA PAPER 90CF0000006	900FR000008
Tipo/Type (2) 	125	25 MICRON	1"	CARTA PAPER 90CF0000001	900FR000001
Tipo/Type (3) 	150	25 MICRON	1" 1/4	CARTA PAPER 90CF0000005	900FR000006
	220	60 MICRON	1" 1/4	RETE METALLICA METALLIC NET 90CF0000004	900FR000007

PROLUNGHE PER FILTRI / EXTENSIONS FOR FILTERS

	A mm	B mm	FILTRO FILTER	CODICE CODE
	40	200	Tipo/type (3)	912SA000024
	32	300	Tipo/type (1) - (2)	912SA000028

catalogo generale *general catalogue*

CONFIGURAZIONI POSSIBILI PER SERBATOI SERIE SP / POSSIBLE CONFIGURATIONS OF TANKS SERIES SP



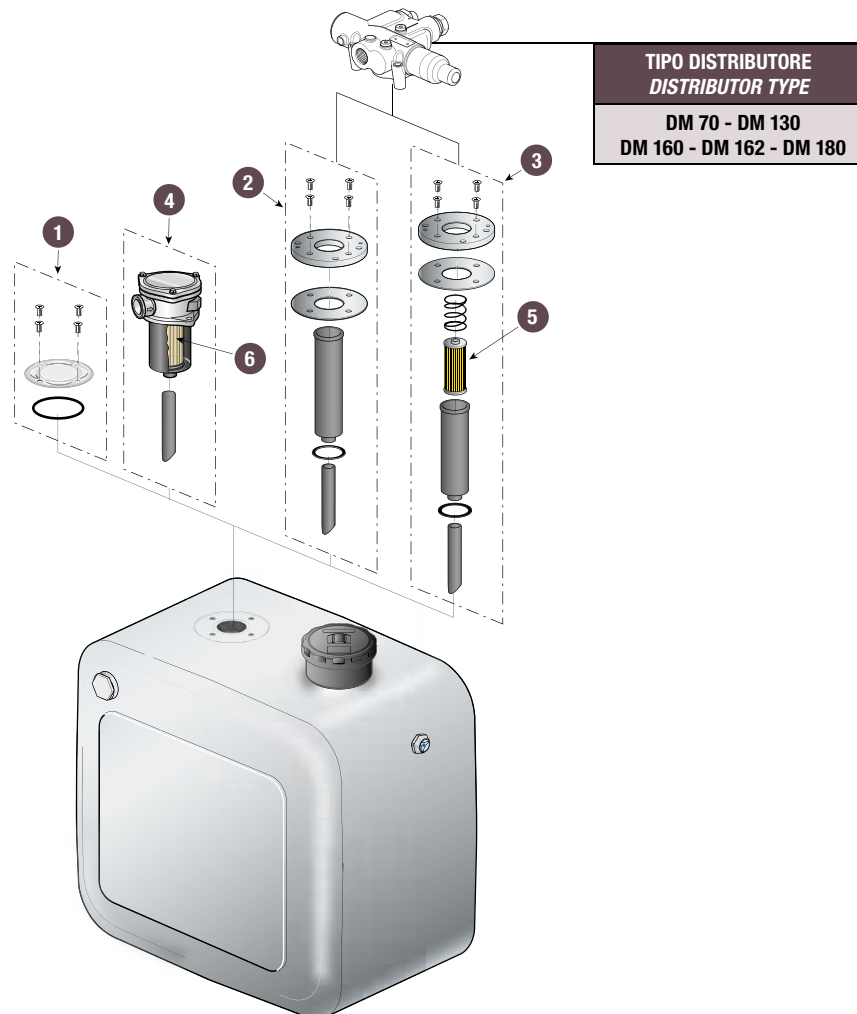







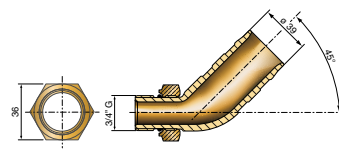

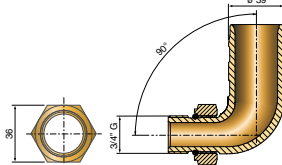

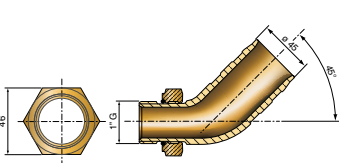
		TIPO DISTRIBUTORE <i>DISTRIBUTOR TYPE</i>	CAPACITÀ SERBATOIO <i>TANK CAPACITY</i>	CODICE <i>CODE</i>
1	Piastra di chiusura (incluso nel serbatoio) <i>Closing plate (in tank included)</i>			907TS000000
2	Piastra fissaggio distributore <i>Distributor mounting plate</i>	DM 70 - DM 130	90 - 100 - 120 - 135 150 - 170 - 200 - 230	30KFPF03000
		DM 160 - DM 162 DM 180		30KFPF02000
3	Piastra fissaggio distributore con filtro <i>Distributor mounting plate with filter</i>	DM 70 - DM 130	90 - 100 - 120 - 135 150 - 170 - 200 - 230	30KFPF01000
		DM 160 - DM 162 DM 180		30KFPF00000
4	Filtro <i>Filter</i>		90 - 100 - 120	30KFP000000
			135 - 150 - 170 - 200 - 230	30KFP010000
5	Cartuccia metallica 60 micron <i>Metallic cartridge 60 micron</i>			90CF0000004
6	Cartuccia carta 25 micron <i>Paper cartridge 25 micron</i>			90CF0000001

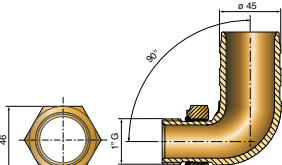

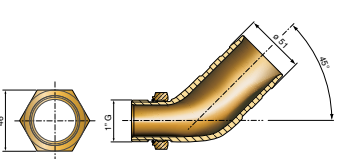
SERBATOI TANKS

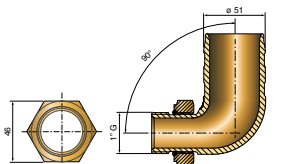

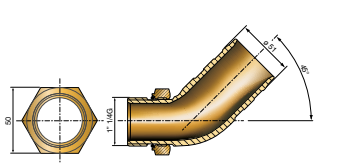

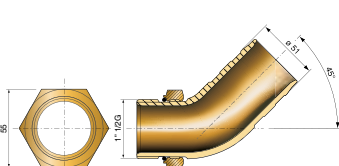
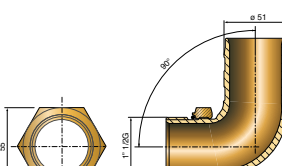

catalogo generale general catalogue

Bocchettoni in Ottone a 45° e 90° / 45° and 90° brass fittings

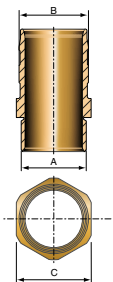

CODICE CODE		ATTACCO GAS GAS PORT	
90021701800		90021702500	
			
		3/4"	
		CHIAVE WRENCH	
		36 (60 Nm)	
		TUBO HOSE	
		ø 39	
CODICE CODE		ATTACCO GAS GAS PORT	
90021701900		90021702400	
			
		1"	
		CHIAVE WRENCH	
		46 (70 Nm)	
		TUBO HOSE	
		ø 45	
CODICE CODE		ATTACCO GAS GAS PORT	
90021702800		90021702700	
			
		1"	
		CHIAVE WRENCH	
		46 (60 Nm)	
		TUBO HOSE	
		ø 51	
CODICE CODE		ATTACCO GAS GAS PORT	
90021702000		90021702200	
			
		1" 1/4	
		CHIAVE WRENCH	
		50 (80 Nm)	
		TUBO HOSE	
		ø 51	
CODICE CODE		ATTACCO GAS GAS PORT	
90021702100		90021702300	
			
		1" 1/2	
		CHIAVE WRENCH	
		55 (90 Nm)	
		TUBO HOSE	
		ø 51	

catalogo generale *general catalogue*



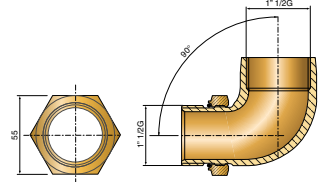

Bocchettoni in Acciaio Diritti / Straight steel fittings

		CODICE CODE	A	ATTACCO GAS GAS PORT	B	TUBO HOSE	C	CHIAVE WRENCH
		90011002062		3/4"		ø 32		34 (60 Nm )
90011002100		3/4"		ø 39		41 (60 Nm )		
90011002101		1"		ø 45		50 (70 Nm )		
90011002157		1"		ø 51		50 (70 Nm )		
90011002102		1" 1/4		ø 51		55 (80 Nm )		
90011002095		1" 1/2		ø 51		55 (90 Nm )		

Raccordo Orientabile in Ottone a 90° M 1" 1/2 - F 1" 1/2
90° adjustable brass fitting M 1" 1/2 - F 1" 1/2

		CODICE CODE	A	ATTACCO GAS GAS PORT	B	TUBO HOSE	C	CHIAVE WRENCH
		90021702600		1" 1/2		1" 1/2		55 (90 Nm )

Rubinetto orientabile / Adjustable tap

	CODICE CODE	A	ATTACCO GAS GAS PORT	B	TUBO HOSE	C	CHIAVE WRENCH
	90021703100		1" 1/2		ø 51		55 (90 Nm )
	90021703400		1" 1/2		ø 43		55 (90 Nm )
	90021703300		1" 1/2		ø 39		55 (90 Nm )

Fascette / Clamps

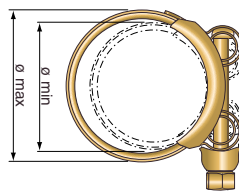
		CODICE CODE	TUBO HOSE	ø min. - max
		09902435000	ø 32	40 - 43
		09902436000	ø 39	48 - 51
		09902437000	ø 45	52 - 55
		09902438000	ø 51	60 - 63